

# REDUCE REUSE RECYCLE

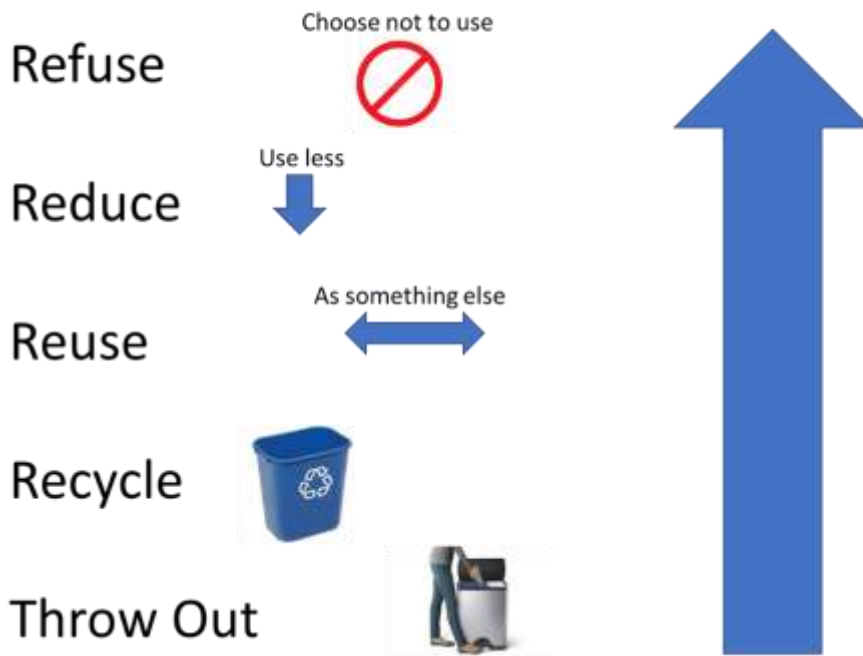

*Although we are each proud to recycle, we are encouraged to “take it up a notch.” Recycling is only one step above throwing out. We are challenged to move up the flow chart and practice “Refuse, reduce, re-use.”*

Starting at the trash can, how can you work your way up the list with these items?



## Local Recycling Guidelines:



American Disposal Guidelines

[Find information Here](#)

Republic Services Guidelines

[Find Information Here](#)

St. John Neumann Guidelines

[Find document here](#)

Reduce waste by Composting and return nutrients to the soil.



[General instructions here.](#)

Bring your kitchen compost ([guidelines here](#)) to the Farmer's Market at St. John Neumann parking lot every Wednesday from mid-April to mid-November. We will take it to a local garden compost pile.

## Dispose of your e-waste properly



The [Basel Action Network](#) has certified recyclers who responsibly and ethically dispose of electronic waste.

Specifically, that means recyclers certified as e-Stewards by the Basel Action Network (BAN), a global toxics trade watchdog group named after the U.N. Basel Convention.

To be certified, recyclers must demonstrate that no hazardous e-waste will be exported to developing countries, deposited in landfills or incinerators, or sent to prison labor operations. The recyclers also erase all data from storage components. E-Stewards is considered the most rigorous standard in the United States.

[Find a certified recycler through the Basel Action Network here.](#)

# Dispose of your Household Hazardous Waste Properly

[From FairfaxCounty.gov](http://FairfaxCounty.gov):

The Fairfax County Household Hazardous Waste Program accepts hazardous materials **from residents** free of charge and disposes or recycles them according to all local, state and federal regulations.

Residents may take their household hazardous waste to one of the permanent collection sites.

- [I-66 Transfer Station](#)  
Household Hazardous Waste Hours
  - Monday - Saturday: 8 a.m. - 4 p.m.
  - Sunday: 9 a.m. - 4 p.m.
- [I-95 Landfill Complex](#)  
Household Hazardous Waste Hours
  - Monday - Sunday: 7 a.m. - 4 p.m.
- [Download Household Hazardous Waste Disposal Program Brochure](#)

## Consider Making your own Gift Wrapping

Instead of using one time gift wrapping paper, try the Japanese method of wrapping with reusable fabric. [Description of furoshiki here.](#)





# How long until it's gone?



Plastic Bags .....	200-1000 yrs
Fishing Line .....	600 years
Disposable Diapers .....	550 years
Plastic Bottles .....	450 years
Aluminum Can .....	200-500 years
Plastic Containers .....	50-80 years
Rubber-Boot .....	50-80 years
Foamed Plastic Cups .....	50 years
Tinned Steel Can .....	50 years
Leather Shoes .....	25-40 years
Cigarette Butts .....	10-12 years
Milk Cartons .....	5 years
Wool Socks .....	1-5 years



**There is no such thing as “away.”**

**When you throw something away, it  
must go *somewhere*.**